

Qty.	Description
1	<p>Liquid temperature range: 5 .. 60 °C Selected liquid temperature: 20 °C Density: 998.2 kg/m³</p> <p>Technical: Max flow: 109 m³/h</p> <p>Materials: Pump housing: Stainless steel</p> <p>Installation: Maximum operating pressure: 10 bar Maximum permissible inlet pressure: PN 10 bar Flange standard: DIN2642 Manifold inlet: DN 100 Manifold outlet: DN 100</p> <p>Electrical data: IE Efficiency class: IE5 Power (P2) main pump: 4 kW Mains frequency: 50 / 60 Hz Rated voltage: 3 x 380-415 V Rated current: 22 A Start. method: electronically Enclosure class (IEC 34-5): IP54</p> <p>Tank: Volume of pressure tank: 18 l Diaphragm tank: Yes</p> <p>Others: Net weight: 276 kg Gross weight: 362 kg Shipping volume: 1.2 m³ Language: GB Country of origin: GB Custom tariff no.: 84137075</p>

99133253 HYDRO MULTI-E 3 CRIE 20-2

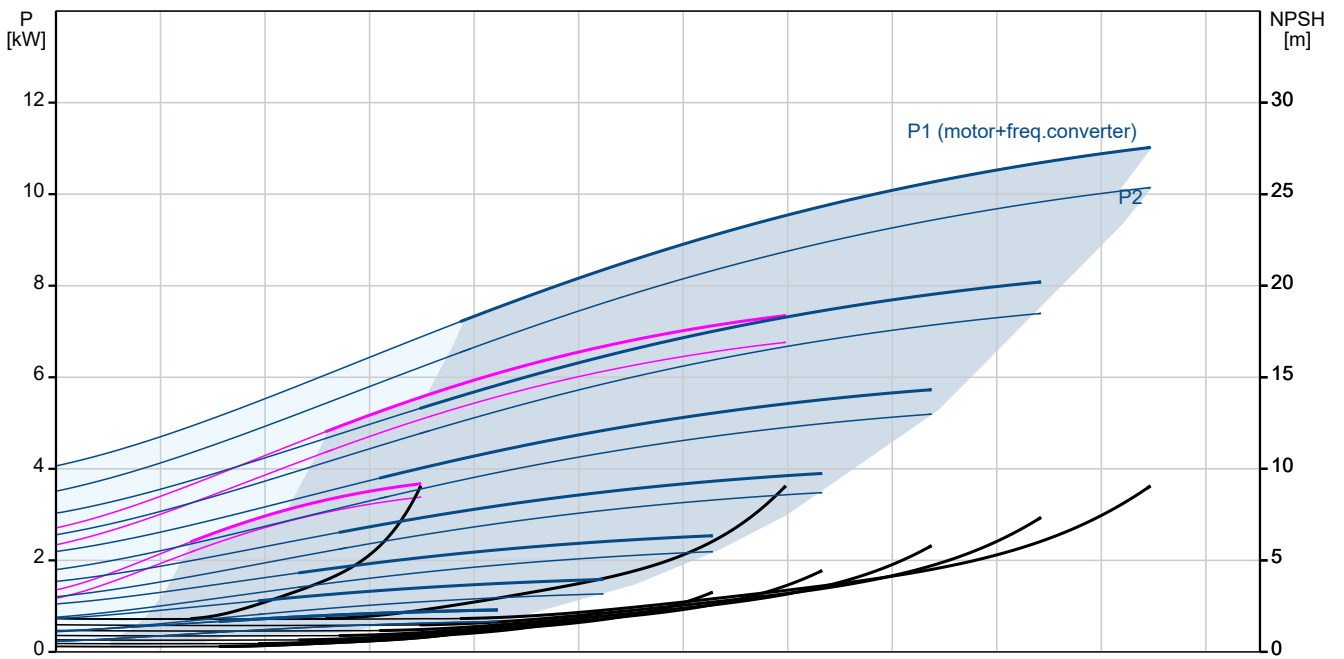

Description	Value
General information:	
Product name:	HYDRO MULTI-E 3 CRIE 20-2
Product No:	99133253
EAN number:	5712607362065
Technical:	
Max flow:	109 m ³ /h
Min flow system:	8.4 m ³ /h
Head max:	42 m
Pump name:	CRIE 20-2
Number of pumps:	3
Materials:	
Pump housing:	Stainless steel
Manifolds:	Stainless steel
Installation:	
Maximum operating pressure:	10 bar
Maximum permissible inlet pressure:	PN 10 bar
Liquid:	
Pumped liquid:	Water
Liquid temperature range:	5 .. 60 °C
Selected liquid temperature:	20 °C
Density:	998.2 kg/m ³
Electrical data:	
IE Efficiency class:	IE5
Power (P2) main pump:	4 kW
Mains frequency:	50 / 60 Hz
Rated voltage:	3 x 380-415 V
Rated current:	22 A
Start. method:	electronically
Enclosure class (IEC 34-5):	IP54
Tank:	
Volume of pressure tank:	18 l
Diaphragm tank:	Yes
Others:	
Net weight:	276 kg
Gross weight:	362 kg
Shipping volume:	1.2 m ³
Language:	GB
Country of origin:	GB
Custom tariff no.:	84137075

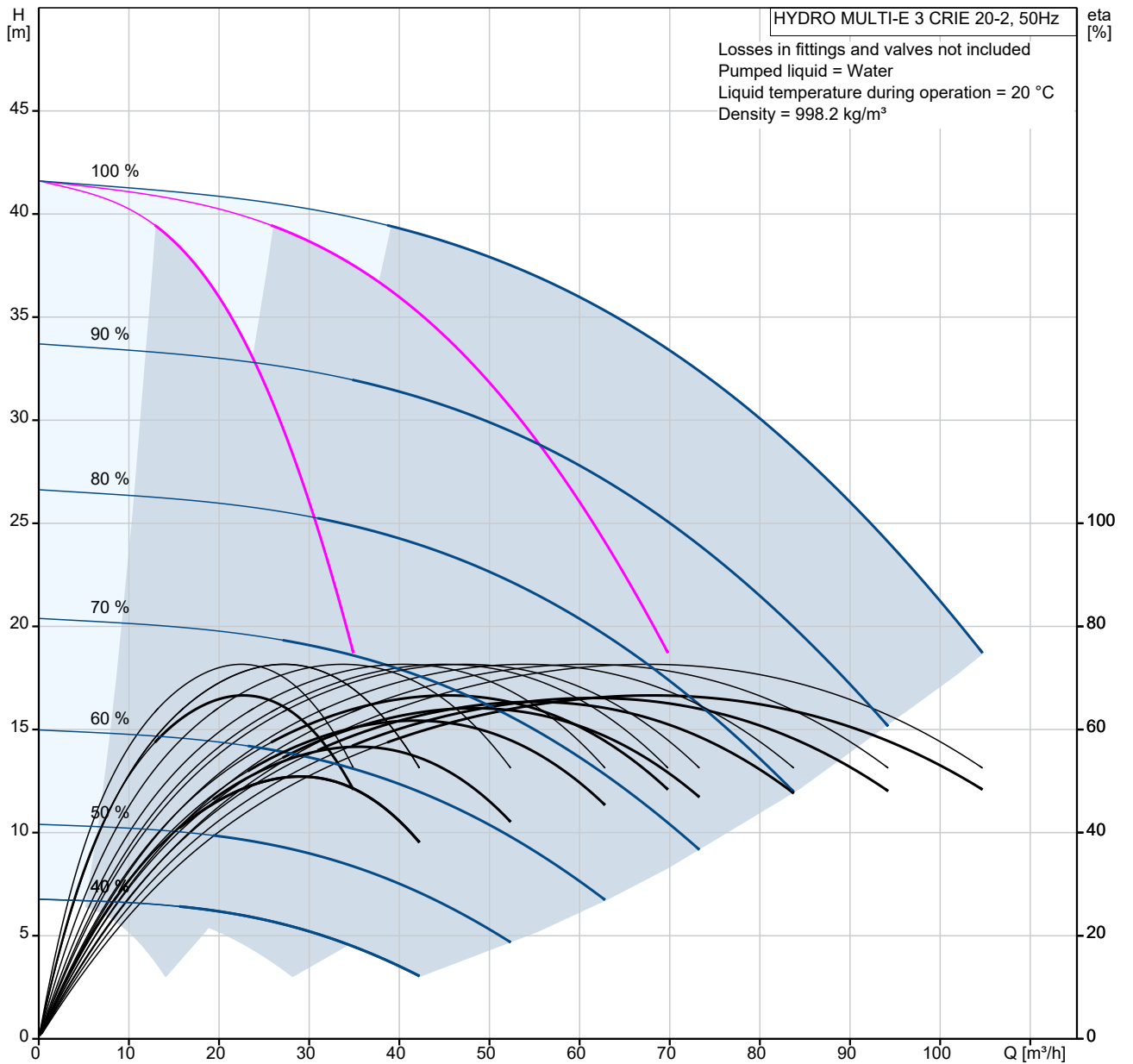
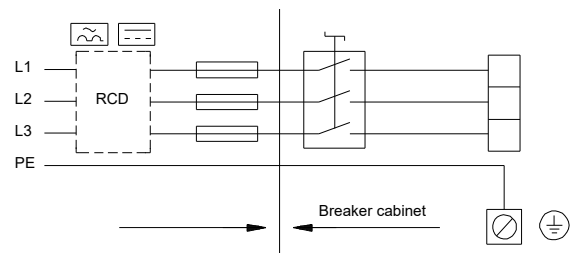
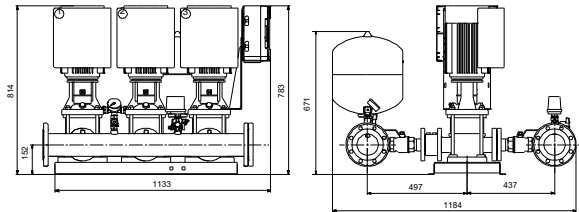
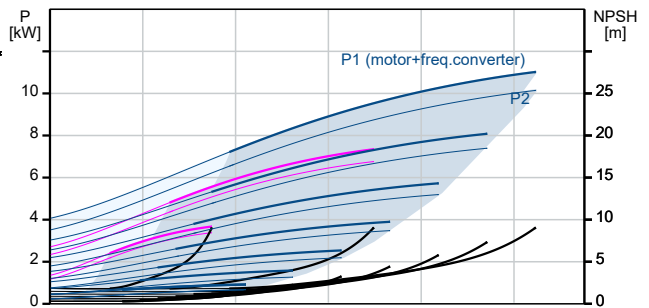
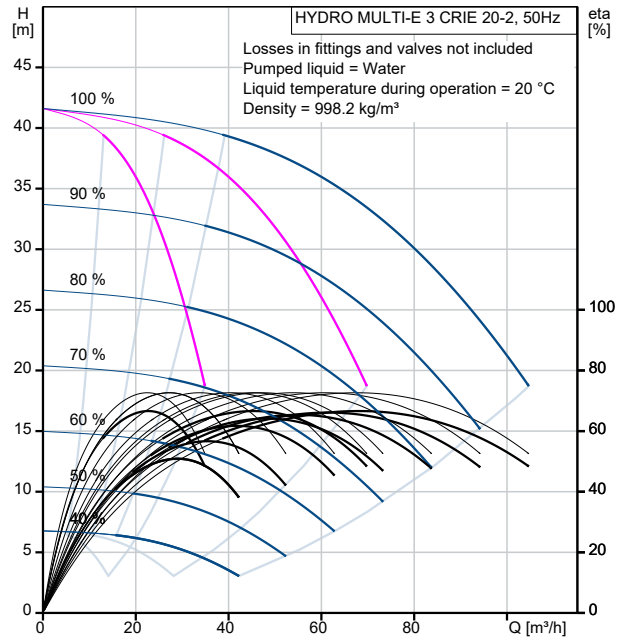

99133253 HYDRO MULTI-E 3 CRIE 20-2

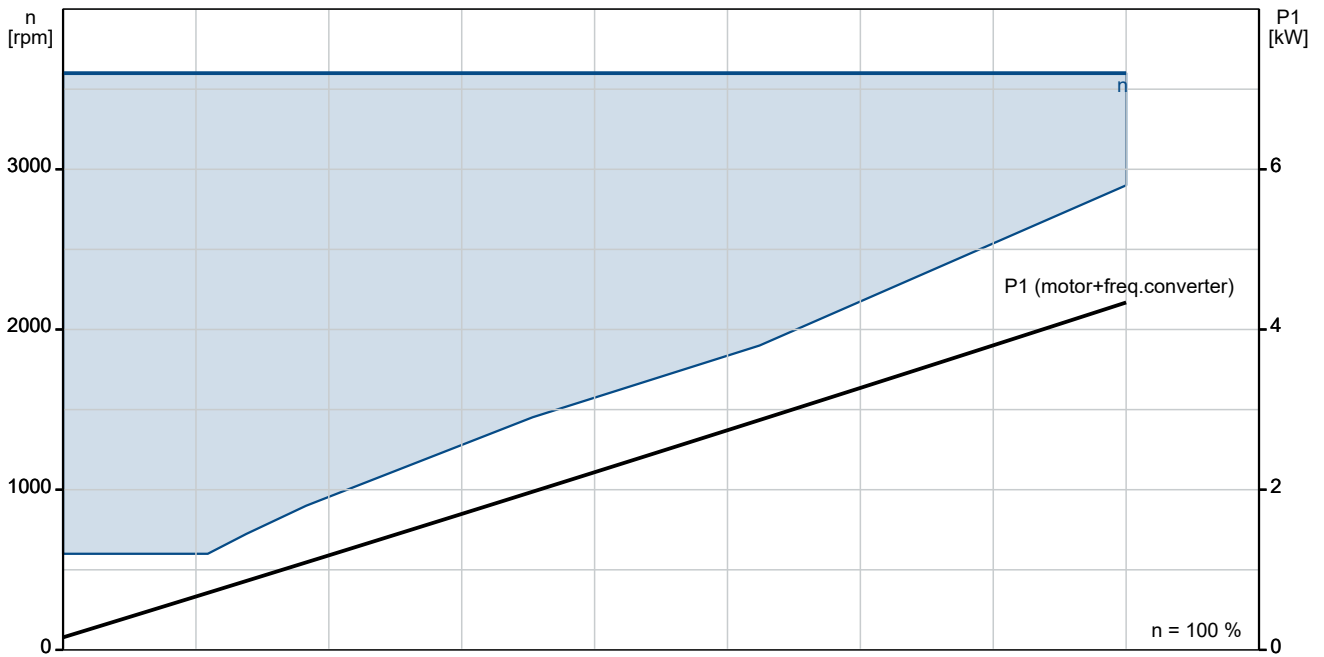
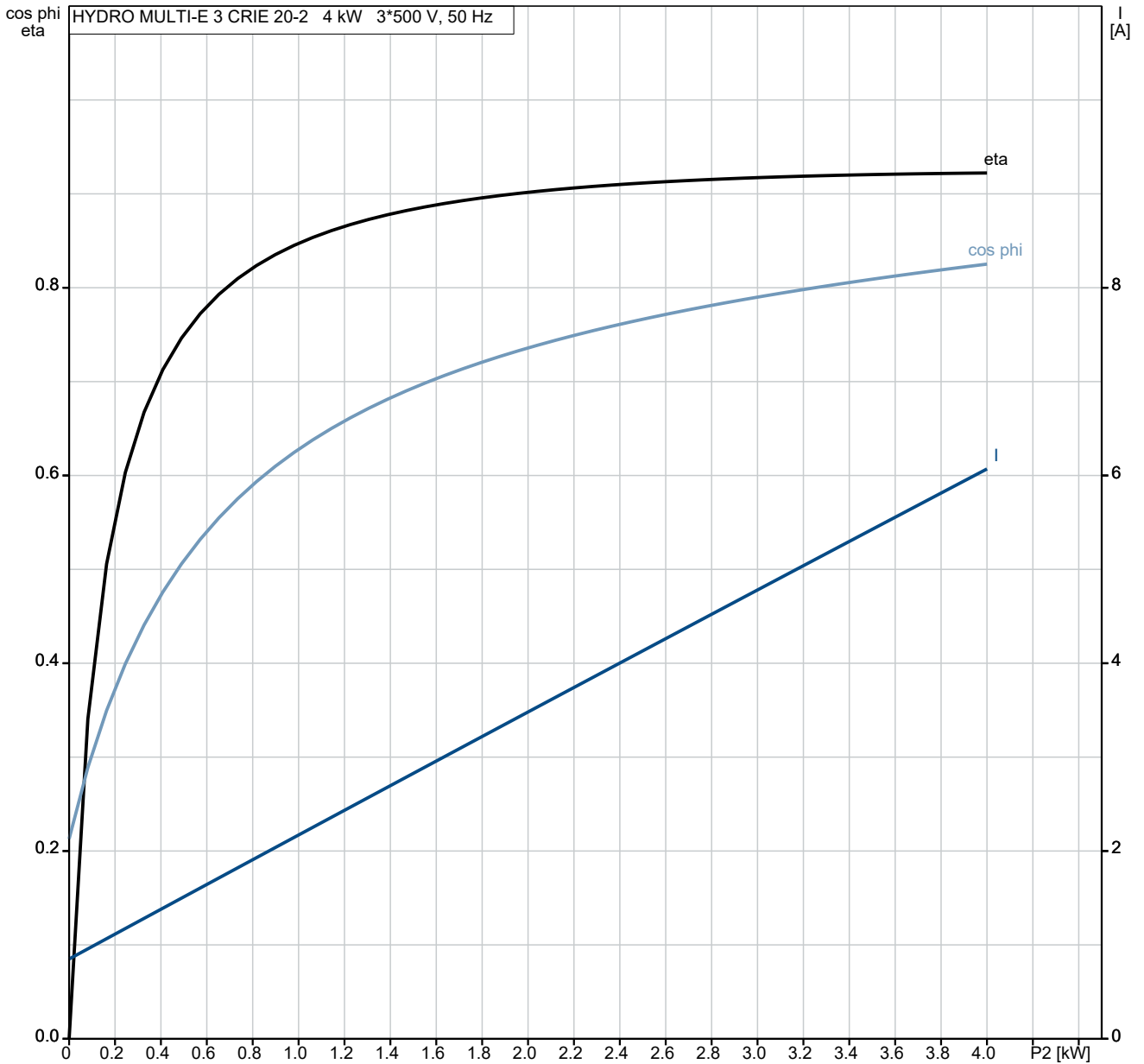

99133253 HYDRO MULTI-E 3 CRIE 20-2

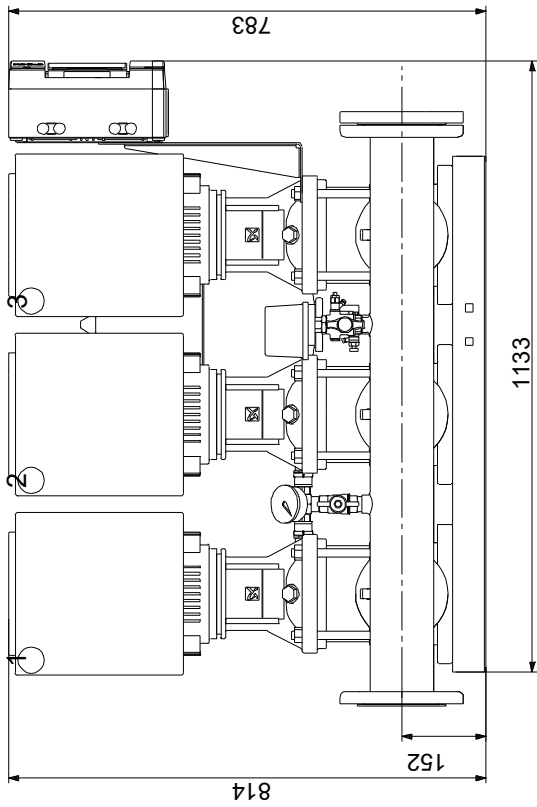
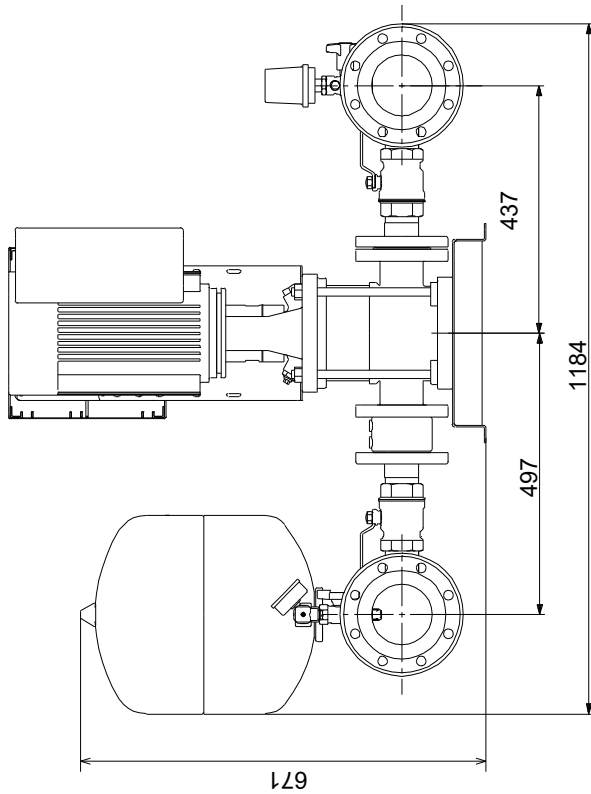

Note! All units are in [mm] unless others are stated.
Disclaimer: This simplified dimensional drawing does not show all details.

99133253 HYDRO MULTI-E 3 CRIE 20-2

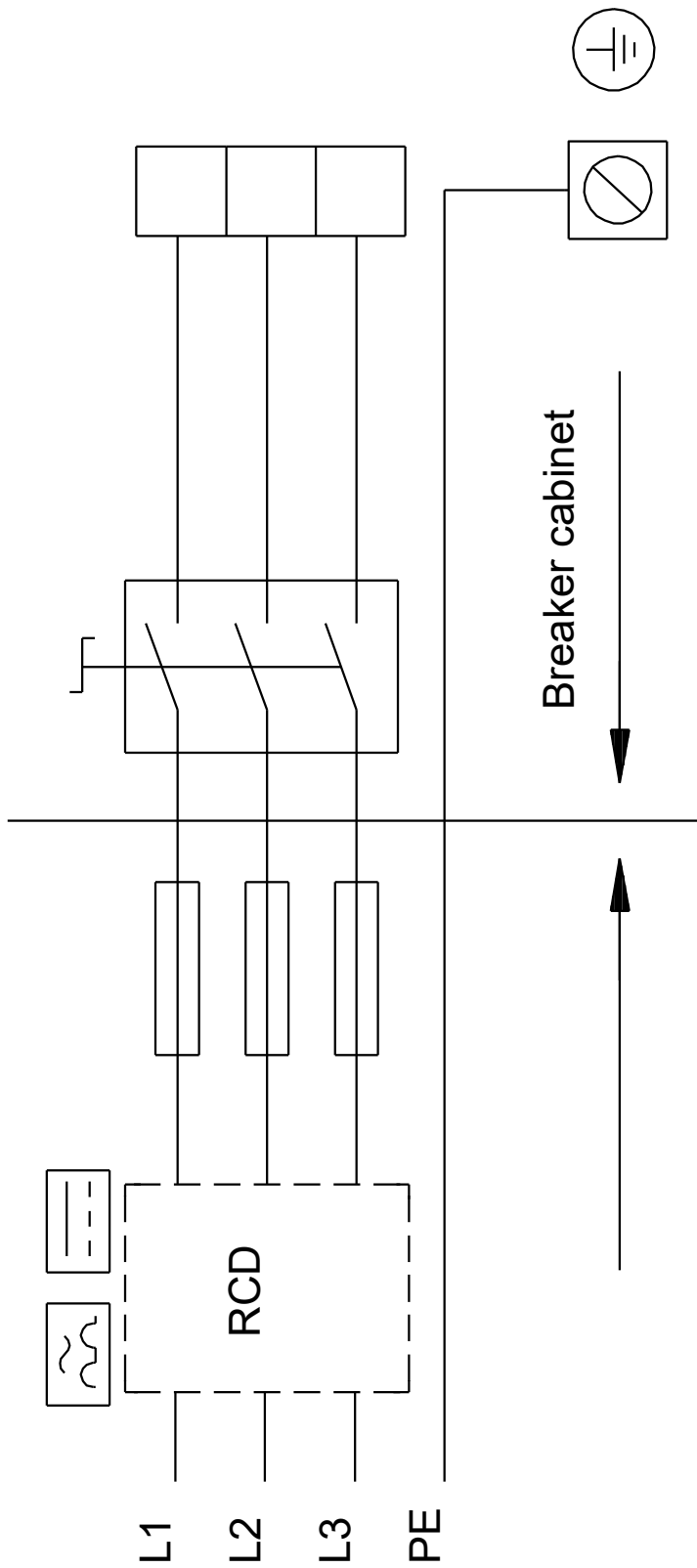

Note! All units are in [mm] unless others are stated.

